

Tech Data

Viega ProPress® Ball Valve Model 2973.1

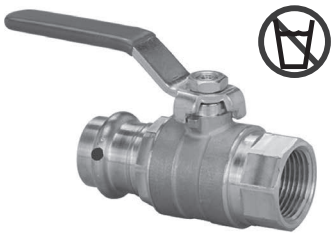

Description

Viega ProPress model 2973.1 is a two-piece, full port ball valve intended for hydronic and non-potable applications. The ball valve features EPDM sealing elements, EPDM stem

seals and Viega's Smart Connect® technology for easy identification of unpressed connections during pressure testing.

Features

- Chrome-plated brass ball
- Blowout-proof stem
- Reinforced PTFE seats
- Smart Connect technology
- Press x FPT connections

Ratings

- 300 CWP
- Temperature range: 0°F - 200°F
- Max. Operating Pressure: 300 psi

Approvals

- Conforms to MSS SP-110
- NSF®-U.P. Code
- IAPMO/ANSI Z1157

ProPress Ball Valve 2973.1 Insulation Thickness

Size (in)	Insulation max w no ext (in)	Insulation max w ext (in)	Extension Part No.
1/2	0.59	2.81	23449
3/4	0.58	3.04	23451
1	0.55	3.01	23451

Component	Material
Body	Brass C37700
Ball	Chrome-plated Brass
Seat	Reinforced PTFE
Stem	Brass C37700
Stem Seals	EPDM
Nut	Zinc-plated Steel
Handle	Zinc-plated Steel
Handle Cover	Polyvinyl
Sealing Element	EPDM



This document is subject to updates. For the most current Viega technical literature, please visit www.viega.us.



Viega products are designed to be installed by licensed and trained plumbing and mechanical professionals who are familiar with Viega products and their installation. **Installation by non-professionals may void Viega LLC's warranty.**

Viega ProPress Ball Valve Bronze/Brass P x FPT - Model 2973.1

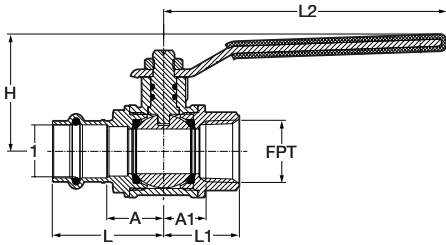

Part No.	Size (in)	A (in)	A1 (in)	L (in)	L1 (in)	L2 (in)	H (in)
1 x FPT							
24030	1/2 x 1/2	0.83	0.63	1.58	1.16	3.94	1.69
24035	3/4 x 3/4	0.95	0.71	1.86	1.26	4.72	1.97
24040	1 x 1	1.18	0.93	2.09	1.59	4.72	2.13



Model 2973.1 is for use in non-potable applications. For NSF-61G compliant valves refer to Viega ProPress model 2971.4ZL.

V Viega LLC
 585 Interlocken Blvd.
 Broomfield, CO 80021

Phone (800) 976-9819
www.viega.us

TD-PP 0823 Ball Valve 2973.1

