

Product Instructions

Viega MegaPress® Pressure Independent Balancing and Control Valve (PIBCV)

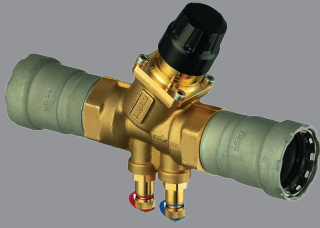

Models 4881.71 / 4887.72



Viega LLC
585 Interlocken Blvd.
Broomfield, CO 80021

Phone (800) 976-9819
www.viega.us

PI-MP 531242 0424 MegaPress Balancing and Control Valve

EN Product Instructions Viega MegaPress Pressure Independent Balancing and Control Valve

This document is subject to updates. For the most current Viega technical literature please visit www.viega.us.

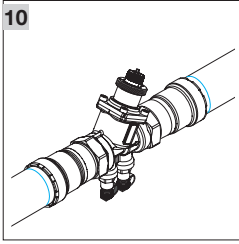
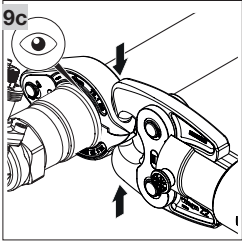
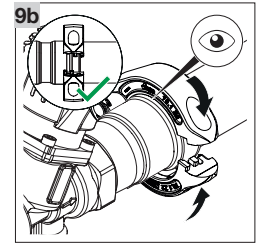
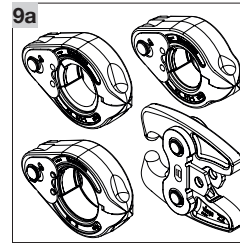
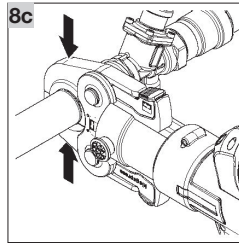
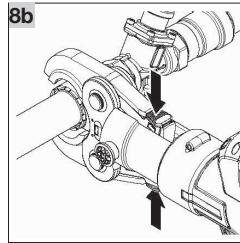
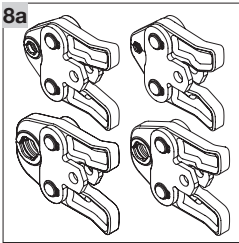
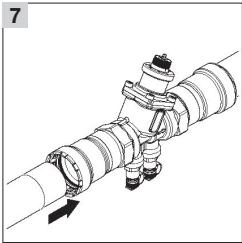
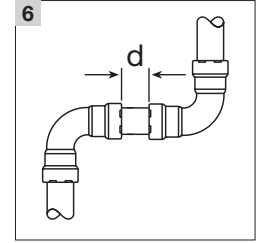
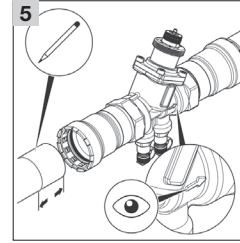
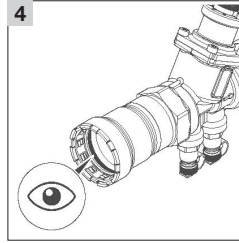
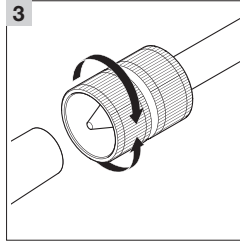
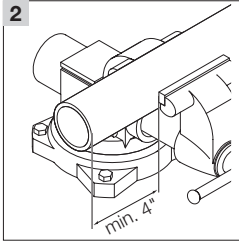
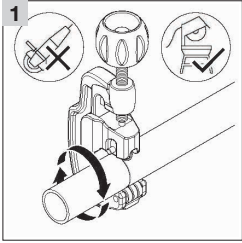

- 3 Remove burr from inside and outside of the pipe and prep to proper insertion depth using a preparation tool or fine-grit sandpaper.
- 4 Check seal and grip ring for correct fit. Do not use oils or lubricants.
- 5 Mark proper insertion depth. Improper insertion depth may result in an improper seal. The depth marking shall be visible on the completed assembly. Ensure the indication arrow on the body matches the correct flow direction of the system.

Warning!
Keep extremities and foreign objects away from press tool during pressing operation to prevent injury or incomplete press.

- 8b Open the MegaPress jaw and place at right angles on the fitting. Visually check insertion depth using mark on the pipe.
- 8c Start pressing process and hold the trigger until the jaw has engaged the fitting. Jaws will automatically release after a full press is made.
- 9a Viega MegaPress 1/4" to 2" connections must be performed with MegaPress rings and V2 actuator. See the tool's Operator's Manual for proper tool instructions.
- 9b Open the MegaPress ring and place at right angles on the valve. The MegaPress ring must be engaged on the fitting bead. Check insertion depth.
- 9c Place V2 actuator onto the MegaPress ring and start the pressing process. Hold the trigger until the actuator has engaged the MegaPress ring.
- 10 Remove MegaPress jaw from valve or release V2 actuator from the MegaPress ring and then remove the MegaPress ring from the valve on completion of press. Repeat steps for the other end of the valve.

EN Viega MegaPress Pressure Independent Balancing and Control Valve

! Viega products are designed to be installed by licensed and trained plumbing and mechanical professionals who are familiar with Viega products and their installation. **Installation by non-professionals may void Viega LLC's warranty.**

DANGER!
Read and understand all instructions for installing Viega MegaPress fittings.
Failure to follow all instructions may result in extensive property damage, serious injury, or death.

! Only valves marked with NSF-61 and NSF-372 are allowed for use in potable water systems.

- 1 Cut pipe square using displacement-type cutter or fine-toothed saw.
- 2 Keep end of pipe a minimum of 4" away from the contact area of the vise to prevent possible damage to the pipe in the press area.

Viega MegaPress Insertion Depth Chart (in)

Pipe Size	1/2	3/4	1	1 1/4	1 1/2	2
Insertion Depth	1 1/16	1 3/16	1 3/8	1 13/16	1 7/8	2

- 6 Refer to the chart below for minimum distance between fittings. To ensure a correct press, a minimum distance between press fittings must be maintained. Failure to provide this distance may result in an improper seal.

Pipe Diameter (in)	d (in)	d (mm)
1/2	1/4	6
3/4	1/4	6
1	1/4	6
1 1/4	1/2	13
1 1/2	1/2	13
2	1/2	13

- 7 While turning slightly, slide valve onto the pipe to the marked depth. End of pipe must contact stop.
- 8a Viega MegaPress 1/2" to 1" fitting connections must be performed using MegaPress jaws. See the press tool's Operator's Manual for proper tool instructions.