

## Compression Fittings for Insulated Piping

### Description

Viega's compression fittings for insulated pipe should only be used on Viega Insulated Barrier Piping. Fittings are available in couplings, elbows, tees, branch-reducing tees, and branch- and run-reducing tees. A PEX to male NPT adapter is included with each fitting termination.

### Features

- Dezincification resistant brass for all fittings and adapters
- No special tools required
- 8 adapter sizes
- 8 coupling sizes
- 8 elbow sizes
- 61 tee configurations

### Specifications

Material: DZR Brass  
 Max Operating Temperature: 203° F (95° C)  
 Max Operating Pressure: 87 psi (6 bar)

### Installation

Installation must follow all guidelines provided by Viega. Approved for direct burial when properly threaded, insulated, and tested.

### Thread seal methods

Viega does not endorse or sell thread sealing materials. Suitable products are readily available at wholesalers/retailers. Common thread sealing practice should be utilized (thread cement, and tape and dope, etc). These methods apply to all fittings including couplings, elbows, and tees.

### Pressure testing

Pressurize the system to not less than 100 psi or 1.5 times the working pressure of the system. Do not exceed pressure rating of the piping.

- Carry out test for one hour
- Pressure test should be conducted before during and after back filling
- Do not use water as a test medium in situations where it may freeze
- If leak is detected, repair and re-test

Once the system is deemed leak free the fittings may be insulated and system can be buried.

### Schematic

PEX compression to male NPT adapter

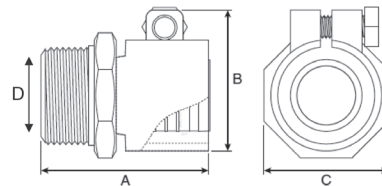

PEX Nominal Size		NPT Size	Part No	A		B		C		D		Weight	
in	mm	in		in	mm	in	mm	in	mm	in	mm	lb	g
¾	25	¾	11530	1⅞	48	1½	38	1⅞	29	.78	20	0.50	225
1	32	1	11570	2⅞	60	1⅞	48	1⅝	42	.98	25	0.77	350
1¼	40	1¼	11604	2⅞	72	2½	63	2⅞	54	1.25	32	1.50	680
1½	50	1½	11605	3⅞	79	3⅞	79	2⅞	61	1.57	40	2.10	950
2	63	2	11606	3⅞	97	3⅞	97	2⅞	71	1.96	50	3.50	1570
2½	75	2½	11607	4	102	4¼	107	3⅞	86	2.36	60	4.10	1850
3	90	3	11608	5⅞	137	5⅞	148	5⅞	130	2.95	75	7.14	3240
4	110	4	11609	5⅞	147	6⅞	175	5⅞	147	3.54	90	9.00	4080

# TechData



PEX compression coupling

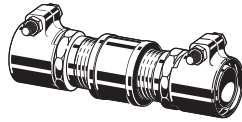

PEX Nominal Size		NPT Size	Part No
in	mm	in	
3/4	25	3/4	11531
1	32	1	11571
1 1/4	40	1 1/4	11610
1 1/2	50	1 1/2	11611
2	63	2	11612
2 1/2	75	2 1/2	11613
3	90	3	11614
4	110	4	11615

PEX compression elbow

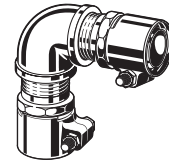

PEX Nominal Size		NPT Size	Part No
in	mm	in	
3/4	25	3/4	11535
1	32	1	11573
1 1/4	40	1 1/4	11616
1 1/2	50	1 1/2	11617
2	63	2	11618
2 1/2	75	2 1/2	11619
3	90	3	11620
4	110	4	11621

PEX compression tee

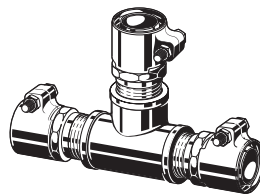

Compression Tee Configurations									
Branch Size	Run Out Size								
	3/4	1	1 1/4	1 1/2	2	2 1/2	3	4	
Run In Size	3/4	3/4							
	1		1						
	1 1/4		1	3/4, 1, 1 1/4					
	1 1/2			3/4, 1, 1 1/4	3/4, 1, 1 1/4, 1 1/2				
	2				3/4, 1, 1 1/4, 1 1/2	3/4, 1, 1 1/4, 1 1/2, 2			
	2 1/2					3/4, 1, 1 1/4, 1 1/2, 2	3/4, 1, 1 1/4, 1 1/2, 2, 2 1/2		
	3						3/4, 1, 1 1/4, 1 1/2, 2, 2 1/2	3/4, 1, 1 1/4, 1 1/2, 2, 2 1/2, 3	
	4							3/4, 1, 1 1/4, 1 1/2, 2, 2 1/2, 3	3/4, 1, 1 1/4, 1 1/2, 2, 2 1/2, 3, 4

Viega products are designed to be installed by licensed and trained plumbing and mechanical professionals who are familiar with Viega products and their installation. **Installation by non-professionals may void Viega LLC's warranty.**

This document is subject to updates. For the most current Viega technical literature please visit [www.viega.us](http://www.viega.us).

Viega LLC • 585 Interlocken Blvd. • Broomfield, CO 80021 • Phone (800) 976-9819 • [www.viega.us](http://www.viega.us)